

## TECHNICAL DRAWING

## TECHNICAL DATASHEET

Our Small Base Single & Dual Power Posts are compact in design and ideal for creating a centralised power distribution or grounding point. Several configurations are available in order to suit a variety of applications.

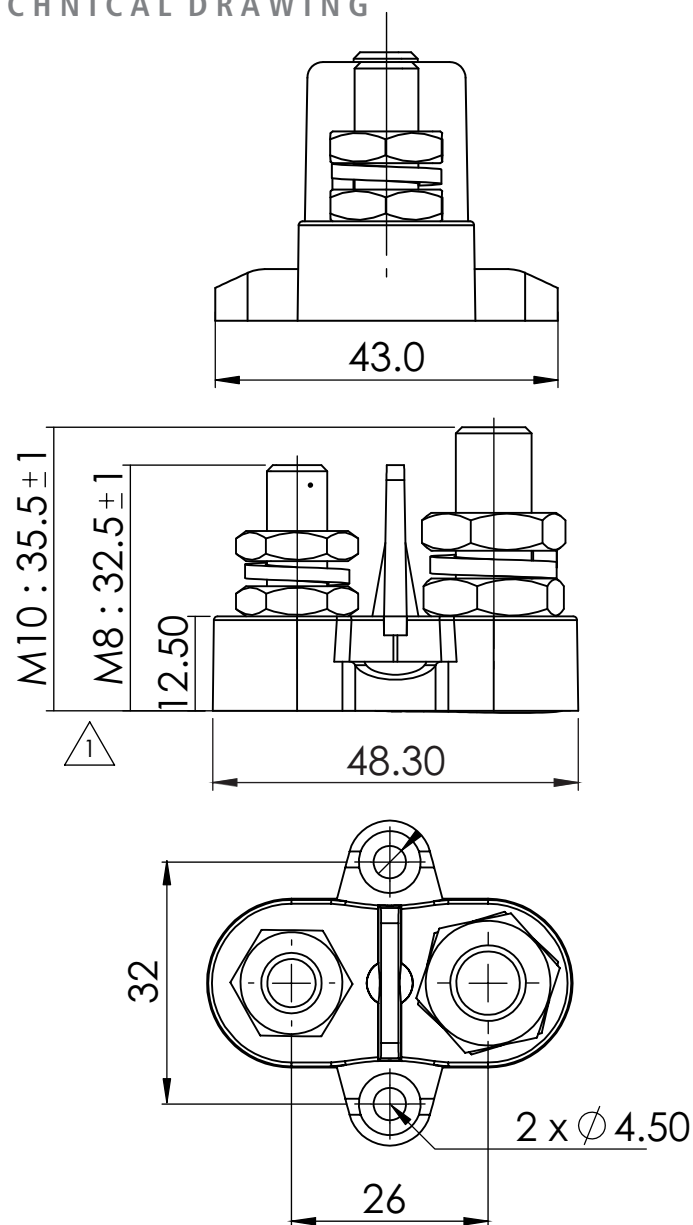
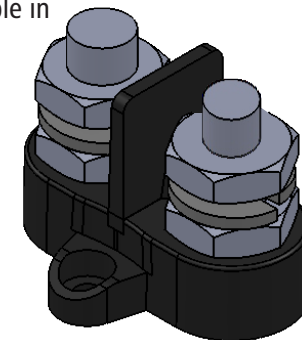

### SPECIFICATIONS

PART NUMBER:	DESCRIPTION:	POST SIZE:	COLOUR:
SBBK_DPD-M8M10	Small Base - Dual Power Post with Isolating Plate	M8M10	BLACK
Base Material:	Nylon, Glass Fibre Reinforced		
Stud Material:	Stainless Steel		
Screw Nuts Material:	Nickel-Plated Brass		
Max Operating Voltage:	DC 48V		
Max Amp per Circuit:	Determined by Wire Size Connected		

### FEATURES

Allows terminating of heavy-duty cables for one or more connections

Available in Red or Black

Glass Fibre reinforced Nylon base ensures great mechanical strength and durability

Insulated Base ensures no current leakage to mounting positions

Heavy Duty Terminal Studs (up to M10)

Small Base allows for easy installation in tight spaces